

REV	ECN NO.	APPD
A	HC-14-0028	PROLOM
B	HC-15-0056	PROLOM

规格 Specifications

额定负荷 Rating	DC 12V/50mA
接触电阻 Contact Resistance	100mΩ max.
绝缘电阻 Insulation resistance	DC100V 60S 100MΩ min.
抗电强度 Dielectric strength	AC250V (50~60Hz) 60S min.
操作力 Operation force	≤180±30gf ≥250±50gf
寿命试验 Operating life	100,000cycles 100,000cycles
行程 Travels	看左侧编码说明

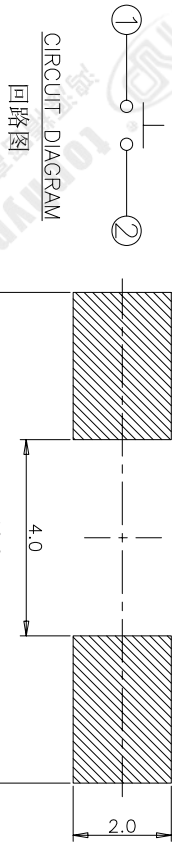

RECOMMENDED P.C.B. LAYOUT

安装尺寸图

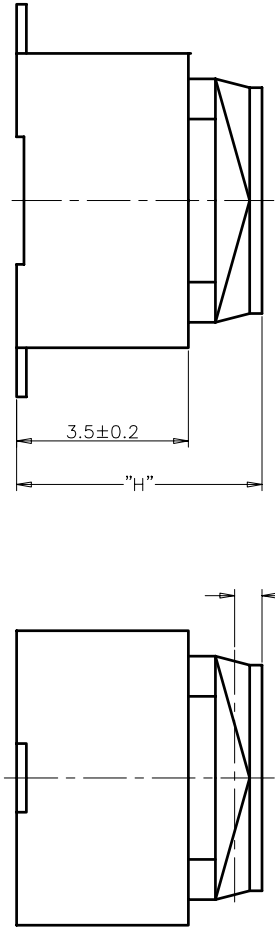

PRODUCT NO.: 1TS009\*\*\*\*\*-CT

轻触开关  
TMKV系列  
外形:  
A=弧盖弯脚  
B=平盖弯脚  
C=弧盖平脚  
D=平盖平脚  
按钮颜色:  
底座颜色:  
盖板颜色:  
操作力度:  
手感:  
材质:  
产品高度 (H):  
行程 Travels

0=常规  
1=新增材质  
依次增加  
0=常闭  
1=大手感  
2=小手感  
3=特殊手感  
430=4.3mm (行程: 0.7±0.2mm)  
500=5.0mm (行程: 1.3±0.3mm)  
160=160±30gf  
180=180±30gf  
250=250±50gf  
260=260±50gf  
280=280±50gf  
300=300±50gf  
初始颜色  
则不启用

ITEM	PART NAME	QUANTITY	MATERIAL	FINISH
5	COVER	1	LCP	BLACK
4	ACTUATOR	1	SILICONE	/
3	CONTACT	1	STAINLESS STEEL	Ag-PLATED
2	TERMINAL	2	BRASS	Ag-PLATED
1	HOUSING	1	LCP	BLACK

X. ± 0.3	X' ± 3'	UNITS	MM	NAME (INTENDED USE)	TMKV SERIES	TACT SWITCH	HON YUAN	HON YUAN PRECISION IND. CO., LTD.	SHENZHEN, CHINA, R.O.C.
.X ± 0.2	.X' ± 2'	MAT'L		PART NO. (INTENDED USE)	1TS009C-****-****0		PRODUCT DRAWING		
.XX ± 0.1	.XX' ± 1'	FINISH		APPD:					
.XXX ± 0.05	.XXX' ± 0.5'			CHKD:					
		QTY		DR: Y.Y.Chen	2015-11-10				
				DWG NO.:	1TS009C				
				SCALE	SHEET	REV.			
				10/1	1/1	B			

THESE DRAWINGS AND SPECIFICATIONS ARE THE PROPERTY OF HON YUAN PRECISION IND. CO., LTD. AND SHALL NOT BE REPRODUCED OR USED IN ANY MANNER WITHOUT THE PRIOR WRITTEN CONSENT OF HON YUAN PRECISION IND. CO., LTD.